

6. EXTERNAL CONNECTION AND MEDIA PLAYER

MP3 music files are audio compression format. This unit can play MP3 directly from files contained on a USB Memory Stick, SD Card.

USB DEVICE OPERATION

1. Insert the USB Device

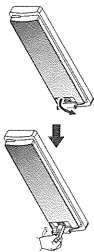

2. Insert the USB device into the USB socket. The unit starts playing from the USB device automatically.

NOTE

Ensure that the USB device contains playable music.

Remove the USB Device

Before remove the USB stick from the front panel, Always remember to switch off the unit's power then remove out the USB Stick.

MEMORY CARD OPERATION

Insert the Memory Card

1. Press panel button to release the front panel.
2. Push the left side of the panel rightward. Pull the panel towards you to disengage it from the chassis.
3. Insert the card into the card slot in the correct direction until a "CLICK" sound is heard.
4. Close the front panel, then the unit starts playing from the card automatically.

E - 5

Remove Memory Card

Press the unit off. Press the card until you hear a click sound, the card is now disengaged, then remove the card.

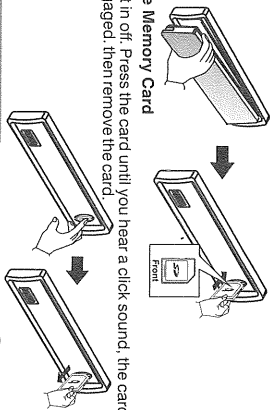

CONNECT THE AUX-IN

Connect the external signal to AUX in jack located at the front of the panel, then press Mode button to select Aux mode. Press Mode Button again to cancel Aux Mode and return to previous mode.

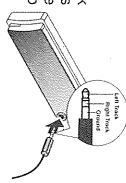

RESET THE UNIT

You can reset the unit to its default setting.

- The RESET button is located on the main unit (as shown on the diagram). To press it vertically with a ballpoint pen or metal object will activate it.
- The reset button is to be activated for the following reasons:
 1. Initial installation of the unit when all wiring is completed.
 2. All the function buttons do not operate.
 3. Error symbol on the display.



6. iPod / iPhone OPERATION

This unit is equipped with iPod/iPhone Ready function which allow end user to have direct control of the iPod/iPhone on the front panel control button and display. iPod/iPhone song information on the unit's LCD display. Please read below for more details operation.

Compatible iPod/iPhone

Apple iPod and iPhone models with a 30-pin dock connector:

Made for:

- iPod nano (2nd generation)
- iPod nano (3rd generation, 4GB only)
- iPod nano (3rd generation, 8GB only)
- iPod nano (4th generation)
- iPod nano (5th generation)
- iPod classic (1st generation)
- iPod classic (2nd generation)
- iPod touch (1st generation)
- iPod touch (2nd generation)
- iPod video (30GB, 80GB only)

Works with:

- iPhone
- iPhone 3G
- iPhone 3GS
- iPhone 4

Connect iPod / iPhone

Insert the iPod/iPhone USB cable to the Front Panel USB socket, the unit starts playing iPod/iPhone automatically.

E - 6

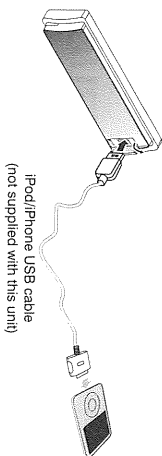

iPod/iPhone control music playback mode

Long press | control/info button on front panel to switch between the two control modes:

- **i control mode:** Use the iPod/iPhone to operates music control.
- **Panel control mode:** Use the Panel buttons on unit to operates the music control.

NOTE

Please make sure the iPod/iPhone cable is connected correctly. And please only use original iPod / iPhone cable.

Search for a track on iPod/iPhone

1. Press BAND/Q to browse iPod/iPhone menu.
2. Rotate Encoder Volume knob to select the Artist search mode, and press 'Power/Mute' button to confirm.
3. Rotate Encoder Volume knob to select the Artist, then press 'Power /Mute' button to confirm.
4. Rotate Encoder Volume knob to select desired song in the current album, press 'Power/Mute' button to confirm.

7. TROUBLE SHOOTING

Before going through the check list, check wiring connection, if any of the problems persist, after check list has been made, consult your nearest service dealer.

No power or no sound

- Car engine is not on. Turn the car engine on.
- Cable is not correctly connected. Check connections.
- Fuse is burnt. Replace fuse.
- Volume is in minimum. Adjust volume to a desired level.
- If the above solutions cannot help, press the RESET button.
- Ensure that the track played is of a compatible format.

Noise in broadcasts

- Signals are too weak. Select other stations with stronger signals.
- Check the connection of the car antenna.
- Change broadcast from Stereo to mono.

8. PRODUCT INFORMATION

Power Supply	12 V DC (11-14 V), Negative Ground
Fuse	15A
Suitable Speaker	4 - 8 Ω
Impedance	
Power output	40W x 4 channels
Pre-AMP output voltage	2.0 V (USB play mode, 1KHz, 0dB, 10 kΩ load)
Aux-In level	≥ 300mV
Radio	
-FM	
Frequency Range	87.5 - 108MHz (100KHz per step in auto search and 50KHz per step in manual search)
Usable Sensitivity	Better than 15dB at S/N 30dB
-AM(MW)	
Frequency Range	522 - 1620KHz
Usable Sensitivity	Better than 45dB
USB devices:	
USB flash memory	USB 1.1, & 2.0 compatible

Supported formats:

MP3/22.5/	Layer 2/3
WMA Version	7/8/9
Sampling frequency	
MP3G1	32/44, 1/48 KHz
MP3G2	16/22.05/24 KHz
MP3G2.5	8/11, 025/12KHz
WMA	22/32/44/48KHz
Sampling But rate	
MP3/WMA	32-320Kbps & VBR
ISO9660 Level	1 / 2 & Joliet(unicode)
Max D/R, Count	999
Max D/R, Depth	255
Sorting Method	Tree sorting
Max File/D/R, Name	64Byte
ID3	V1,0/1,1/2,0/2,3(Max 32Byte)
MP3 directory shown	In this manual as "Directory"
MP3 file shown	"Track".
Maximum length of file name	28 characters.
Maximum length of directory	16 characters.
Supports Multi-Session recording.	

NOTE

Product information is subject to change without prior notice.