

stadium

LED

MULTICOLOUR STRIP LIGHTING

SMD5MP USER GUIDE



CONTENTS

- 1 X 5 Metre RGB SMD LED Strip
- 1 X Flexible joiner
- 1 X RGB Control box
- 1 X Power adapter
- 1 X Wireless remote controller
- 1 X Alcohol cleaning wipe

FEATURES

- 5 Metre RGB SMD LED Strip
- Wireless remote control
- Low power consumption
- Adjustable light intensity (Dimmer)
- Light transitions (Flash, Strobe, Fade, Smooth - speed controlled using brightness buttons)
- 16 Colour presets
- Water resistance rating IP54

SPECIFICATIONS

- Power supply model: (XY24Z-1202000H-AW)
Approval number: SAA-192115-EA
Input voltage: AC100 -240V
Output voltage: DC12V
Total: 24W
- RGB remote Control Box:
Input voltage: DC12V
Output Voltage: DC 12V 2A X 3 Channels
Total: 36W
- SMD LED strip:
Input voltage: DC12V
Total: 24W Max
Length 5 Metres

ASSEMBLY INSTRUCTIONS

Connect the LED Strip male connector into the RGB Control box as shown in the picture below. From there you then connect the Power supply to the RGB Control box as the picture also shows below. The other cable on the Control Box is the IR sensor for the Remote.

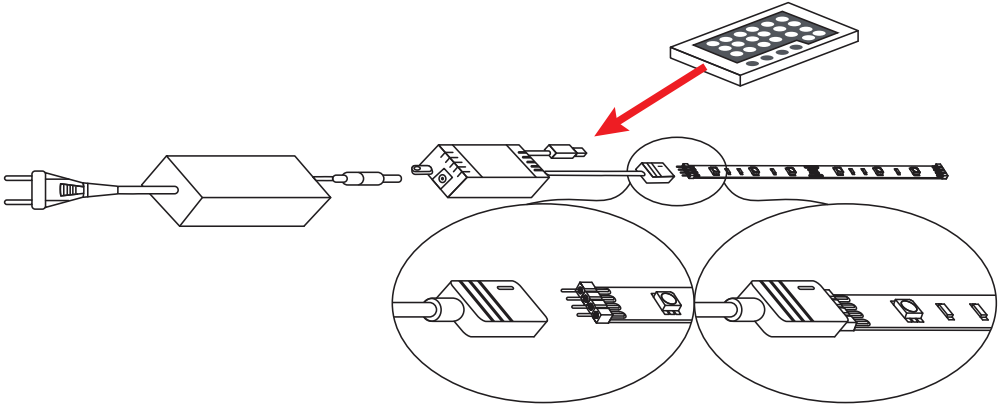

If you would like to shorten the LED strip simply cut across the copper contacts with scissors as shown below.

NOTE: that you do not cut the wrong end of the LED Strip.

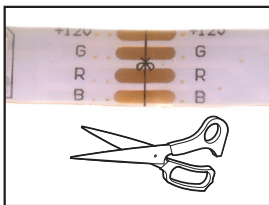

1. Cut along black line marked with scissor icon

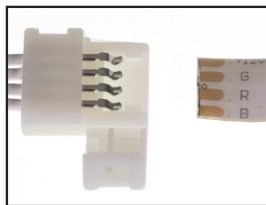

2. Use extension to connect

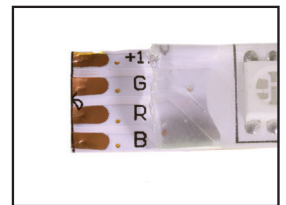

3. Remove silicone to expose copper contacts

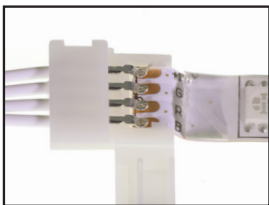

4. Slide the copper contacts under the metal contacts on the extension for connection

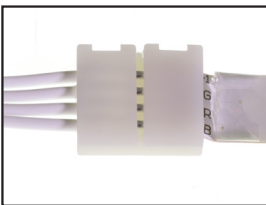

5. Snap close cover to secure

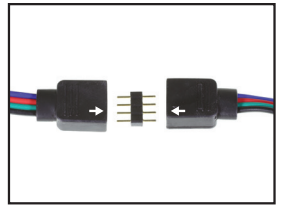

6. The alternative to cutting is to use the adapter joiner at ends of LED strip to join strips together. Arrows on joiners show orientation

ADHERING TO A SURFACE

To stick the LED strip onto a surface, simply peel off the paper sticky underside as shown below. Before installation of the LED strip please ensure that you wipe the surface with an Alcohol prep pad (not supplied) to make sure it is free of dust and grease. Press and hold the LED in position for at least 60 seconds for maximum adhesion.

NOTE: Although LED Light Strips can be installed in curved and irregular spaces, avoid sharp bends or bending on the solder joints as you could damage the light strip.

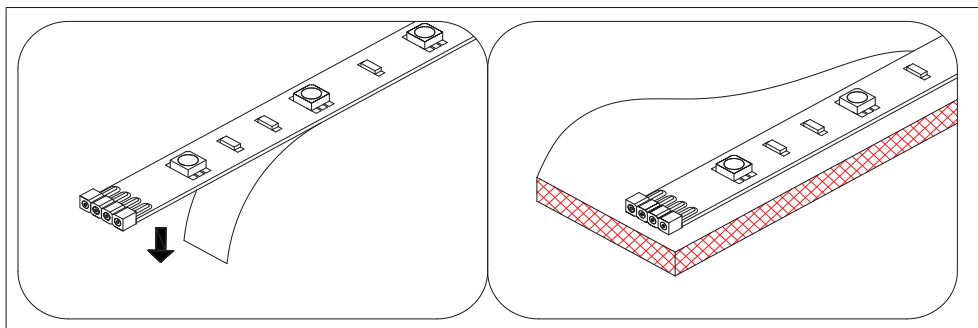

USING THE REMOTE

- Connect the RGB IR remote control box to the LED strip wire, then plug AC/DC Adapter to the remote control box and turn on switch at power source to activate
- Aim and press remote control at IR control box to change functions



WARNINGS

- This product is designed for indoor use only
- The maximum load on the power supply is meant only for 5 meter length in series
- Make sure that the LED strip has been installed correctly before use. If in doubt, contact a qualified electrician
- Do not connect the Power supply and LED strip when they are still in the package
- Do not install near any heat sources to prevent damage to the lighting fixtures from high temperatures
- If the product, cable, LED connector or controller is damaged, contact the retail store you bought this product from before use
- Please do not use anything other than the accessories provided in the package otherwise the product may result in fire, electric shock and/or injury
- Although the LED strip is quite flexible, the smallest possible angle radius is 6 mm
- Do not press too hard on the LED Strip as it may damage the LED's and other components.
- Do not damage the wire connections on the circuit board
- Disconnect the product from the power supply during installation
- This appliance is not a toy. Do not let children play with it.

BATTERY WARNING



The remote control in this product includes a Lithium Button Battery.

- **WARNING - KEEP BATTERIES OUT OF REACH OF CHILDREN**
- Swallowing may lead to serious injury in as little as 2 hours or death, due to chemical burns and potential perforation of the oesophagus.
- If you suspect your child has swallowed or inserted a button battery immediately call the 24-hour Poisons Information Centre on 13 11 26 (Australia) or 0800 764 766 (NZ) for fast, expert advice.
- Examine devices and make sure the battery compartment is correctly secured, e.g. that the screw or other mechanical fastener is tightened. Do not use if compartment is not secure.
- Dispose of used button batteries immediately and safely. Flat batteries can still be dangerous.
- Tell others about the risk associated with button batteries and how to keep their children safe.

TECHNICAL ASSISTANCE

Please retain your proof of purchase receipt in order to make a claim about faulty products or services. If you need assistance setting up or using your Stadium product, or make a claim now or in the future, call Stadium Support. Australia

TEL: 03 – 8587 8898

FAX: 03 – 8587 8866

Mon-Fri 9am – 5pm AEST

If you would like to download a digital copy of this manual, or other Stadium manuals/software, please visit the <http://stadiumsound.com.au> website and search for the product model number for more information, accessories and products. Alternatively scan the QR code below.



This manual is considered correct at time of printing but is subject to change. For latest manuals and updates refer to the website.