



Road Safety Guard

Instruction Manual



Thank you for purchasing HDDVR308 from our company.
In order to help you operate it correctly. Please read this instruction carefully before using*

Product Picture and Function

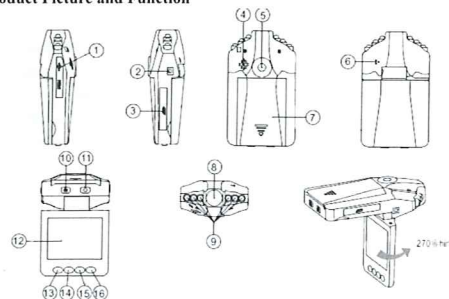

- 1. USB
- 2. AV OUT
- 3. SD/MMC Card Slot
- 4. Speaker
- 5. Mount hole
- 6. Microphone
- 7. Battery cover
- 8. Lens

- 9 IR LED
- 10 ON/OFF POWER SWITCH
- Charging (Red) indicator
- 11 REC/SNAP button
- Working (Blue) indicator
- 12 2.4inch LCD
- 13. Menu
- 14 Down
- 15 Up
- 16 Mode Button

Attached Accessories

- ~ Manual
- ~ Mount
- ~ USB Cable
- *Car Charger (Include the adapter 12V/24V transfers to 5V)

Operate

Two Power options:

A) Use built-in Li-ion battery

DVR can be activated after it has been placed on the vehicle by pressing the Power Switch (10) for 1 second and turn off by pressing it again.

Charging: connect with USB cable or car charger. The indicator display red and convert to no light when it is full

B) Connect with Car Charger

DVR will record automatically when the car starts. Turn off and save the last file when the car stops.

Recording

DVR will enter into defaulted recording mode when turn it on. The work indicator flickers and indicates it is recording. The recording file is saved in the SD/MMC Card. To stop, press Recording Button (1) or ending when car stops. The work indicator won't flicker.

mode. To take photo by pressing SNAP Button (11) .

Preview and Delete

Turn on the DVR and press Mode Button (1 6) twice to enter into Preview Mode. Press Up (15) or Down (14) to select the previewed file if it is video file. It can play or stop) by pressing REC Button if you want to delete it, press Menu Button (1 3) to enter into delete mode, and then, select Single All or Select by REC Button and UP/Down and confirm to delete the file by press Rec Button. Also can select Thumbnail mode and volume (from 1 to 8) under the Preview Mode.

Setting and Function

Turn on the DVR and press Menu Button under Video mode or Camera mode to enter into setting interface. Confirm by REC Button and select by Up 1 Down for the following setting. Press Menu Button again to exit After finished.

A. Video mode

1. Size: Select [1920×1080/1280x720 /640x480pixels]
2. Time Stamp: Select On/Off
3. Motion Detect: Select On/Off

Note: When select Motion detect function, it will be recording automatically if there is an object movement and stop recording if no movement

4. Audio Record: Select On/Off
5. Recording time: select [2/5/15] minute to decide how many time will be stored per one section.

B. Camera mode:

1. Size: 1.3M/VGA

C. Setting Mode :

Whether under Video mode or capture mode, press Menu Button twice to enter into Setup interface.

1. Format: Select it if you want to format the SD card.
2. Language: Select [English/Simplified Chinese/Traditional Chinese/ Japanese/Russian/Polish]
3. System Reset: Select [Cancel or Execute system] reset
4. Light Frequency: set [50/60Hz].
5. Date Input: Set correct recording Date and time by Rec Button and Up/Down Button.
6. IR LED: Auto or Off

USB Mode

Connect DVR with computer by USB cable,(my computer)will occur removable disk,the file is stored at Removable Disk/DCIM/100DSCIM.

At the moment,the file of the DVR can be downloaded to the computer.

Note:1)Please insert the SD/MMC card before recording.

2)This DVR records in cycle if you choose 2/5/15 minutes as storage time. When the storage medium is full, it will record from the beginning again and erase over the previously recorded material automatically. It will have 3 seconds pause time, and namely the contents in the 3 seconds will not be recorded.

3)Because the DVR is DC5V input, please use the attached car charger. It has an adaptor 12V/24V transfers to 5V already.

Technical Specifications

- 1) Recording resolution: 1920x1080/ 1280x720 /640x480 pixels
- 2) Video format: AVI
- 3) Repeat storage by section: 2/5/15 minutes
- 4) Power source: Built-in rechargeable battery or 12V/24V Car Charger
- 5) Supports SD/MMC card (From 1GB up to 32GB)
- 6) Microphone: can record sound
- 7) 2.5 inch LCD: 270° Whirl

Small Tip to Save You Big Headache

A DVR is in a way very similar to a computer. If the DVR hangs itself during operation, please follow the procedures below and most likely the DVR can be re-activated:

DVR will restart after press Reset Hole gently by diameter less than 1mm column.

No Further notice will be given for any modification of the technical specification.

USB Mode

Connect DVR with computer by USB cable; [My computer] will occur removable disk, the file is stored at Removable Disk/DCIM/100DSCIM

At the moment, the file of the DVR can be downloaded to the computer

Note: 1) Please insert the SD/ MMC card before recording

2) This DVR records in cycle if you choose 2/5/15 minutes as storage time. When the storage medium is full, it will record

from the beginning again and erase over the previously

recorded material automatically. It will have 3 seconds pause

time, and namely the contents in the 3 seconds will not recorded.

3) Because the DVR is DC5V input, please use the attached car charger. It has adaptor 12V/24V transfers to 5V already.

Technical Specifications

1) Recording resolution: 1920x1080, 1280 x 720,640x480 pixels

2) Video format: AVI

3) Repeat storage by section: 2/5/15 minutes

4) Power source: Built-in rechargeable battery or 12V/24V Car Charger

5) Supports SD/MMC card (From 2GB up to 32GB) **Note: SD Card must be formatted to FAT format only.**

6) Microphone: can record sound

7) 2.4inch LCD: 270° Whirl

Small Tip to Save You Big Headache

A DVR is in a way very similar to a computer. If the DVR hangs itself during operation . Please follow the procedures below and

most likely the DYR can be re-activated:

DVR will restart after press Reset Hole gently by diameter less than 1 mm column.

No further notice will be given for any modification of the technical specification

Camera mode

Turn on the DVR and press Mode Button (16) to enter into Camera