

### Reviewing photos/video:

1. Open the battery cover as picture shown and insert the SD card into RC WINGMAN.

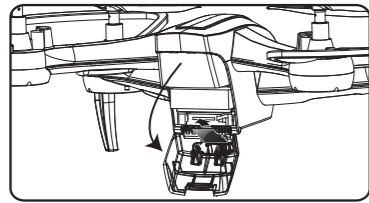

2. After flying, take the SD card out from the camera and insert it into an SD card reader CORRECTLY. (Not included)

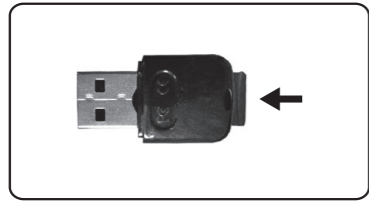

3. Insert the SD card reader into the computer, open "my computer" and you will find related photos and recorded videos.

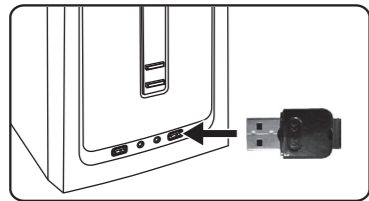

The camera for the WINGMAN is a 720P camera (Resolution: 1280\*720)

### WiFi camera:

#### 1. SOFTWARE DOWNLOAD AND INSTALLATION

- Search 'AERPRO WINGMAN' from App Store or Google Play  
- Download and install it to your smart phone.

#### 2. USING THE APP

- 1). Turn the WINGMAN on.
- 2). Enter the "setting" menu of your mobile device and turn on WIFI.
- 3). Find a network WIFI called "WINGMAN XXXXXX", click connection until "connected".
- 4). Open the "AERPRO WINGMAN" App, click the "play" icon on the control interface to access real time view.
- 5). The interface allows for flight controls as well as streaming and recording.
- 6). Save videos and photos directly to your smartphone.

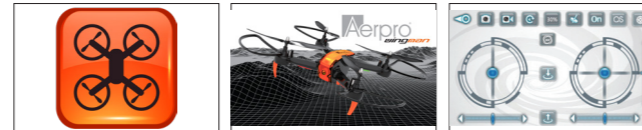

AERPRO WINGMAN App App home screen App interface  
(Instructions and settings for flying and controlling your WINGMAN are included in the App). Some functions may vary for different models.



#### Technical assistance

If you need assistance setting up or using your Aerpro product now or in the future, call Aerpro Support. Australia

TEL: +61 3 8587 8898  
FAX: +61 3 8587 8866

Mon-Fri 9am – 5pm AEST  
Email: service@tdj.com.au



Please retain this user guide for future reference. This manual is considered correct at time of printing but is subject to change. For latest manuals and updates refer to the website.

### Laws & Regulations on flying your drone (AUS)



You need to be able to see the aircraft, with your own eyes (eg, without binoculars) at all times.  
**Don't let it get too far away from you!**



You need to fly the aircraft so it isn't a hazard to other aircraft, property, and people.  
**That means not flying it over areas where there are people.**



**Fly the aircraft in daylight only.**



**Give way to all other aircraft.**

You don't want your aircraft destroyed in a collision with a bigger aircraft, or be responsible for damaging it, or for putting people's lives at risk.



**You cannot fly your aircraft higher than 120 metres (400 feet) above ground level.**



**You cannot fly closer than 5.5 kilometres from an airfield.**

You cannot fly in controlled airspace without a clearance from Air Traffic Control. For more information, see the CASA web site.



**It's illegal to fly for money or economic reward unless you have correct certification from (CASA)**

#### For Further Information:

Model Aeronautical Association of Australia [www.maaa.asn.au](http://www.maaa.asn.au)  
or  
CASA [casa.gov.au/rpa](http://casa.gov.au/rpa) [casa.gov.au/sportaviation](http://casa.gov.au/sportaviation)  
Phone 131 757

### Laws & Regulations on flying your drone (NZ)



You need to be able to see the aircraft, with your own eyes (eg, without binoculars) at all times.  
**Don't let it get too far away from you!**



You need to fly the aircraft so it isn't a hazard to other aircraft, property, and people.  
**That means not flying it over areas where there are people.**



**Fly the aircraft in daylight only.**



**Give way to all other aircraft.**

You don't want your aircraft destroyed in a collision with a bigger aircraft, or be responsible for damaging it, or for putting people's lives at risk.



**You cannot fly your aircraft higher than 120 metres (400 feet) above ground level.**



**You cannot fly closer than four kilometres from any aerodrome.**

You cannot fly in controlled airspace without a clearance from Air Traffic Control. For more information, see the CAA web site.

You can fly outside some of these conditions, but there are more rules to keep you and your aircraft safe, so contact Model Flying New Zealand or the Civil Aviation Authority.

[www.nzmaa.org.nz](http://www.nzmaa.org.nz)

[www.caa.govt.nz/rpas](http://www.caa.govt.nz/rpas)