

FUNCTION KEYS & NAME DESCRIPTION

Serial Number	Function keys / Names	Function / Effect
1	Photo/Video	Tap once to take photo, Long press for 3 seconds to start recording, tap once to stop recording.
2	Power ON/OFF	Press to turn the remote controller on/off .
3	High/low speed	High/Medium/Low Speed, 1 beep = low speed, 2 beeps = medium speed, 3 beeps = high speed.
4	Left stick	Up/down, left/right turn.
5	Right stick	Forward/backward, left/right.
6	N/A	No function on this model
7	Forward/backward trim	If the drone moves forward or backward without any operation, press the trim button backward or forward correspondingly to make it normal.
8	Turn left/right trim	If the drone automatically turns left (right) rotation, press right (left) trim to make it normal.
9	Fly left/right trim	If the drone moves left (right) without operation, press right (left) trim button correspondingly to make it normal.
10	Emergency stop	Push the throttle to the lowest point, then tap the button, the drone will stop and quickly drop.
11	Headless mode	Press this key to enter into headless mode function.
12	N/A	No function on this model
13	One key take-off/landing	Tap the button, the drone ascends. Tap during flight and the drone descends
14	Unlock	Unlock/start motors by pulling both controller sticks down and to the outside corners

REMOTE CONTROL BATTERY INSTALLATION

1. Remove the battery cover from the back of controller (Fig. A)
2. Install 4 "AA" batteries into the controller, make sure to install batteries to their correct polarity. (Fig. B). Do not mix old and new batteries or battery types.
3. Replace the battery cover

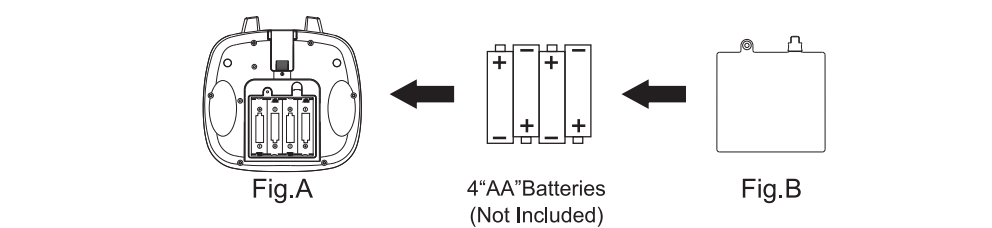

THE INSTRUCTION OF LITHIUM BATTERY CHARGING

- ① Press the aircraft's rear battery module and pull the lithium battery module out of the aircraft battery compartment.(Fig.1)
- ② Insert the charging cable USB plug into the USB power socket, the USB red light is on, and the other end of the charging cable is connected to the charging socket of the lithium battery module. When charging, the LED will automatically extinguish; when the charge is completed, the LED will turn on constantly, then the charging is over. Charging time is about 90-120 minutes. (Fig.2)
- ③ After charging is complete, insert the lithium battery module into the battery slot as shown below.

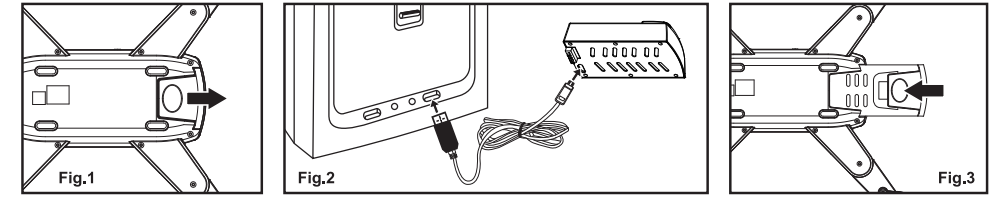

ATTENTION:

1. Make sure the voltage of the USB charger fits the local electricity supply.
2. The Charging plug will overheat if overcharged. Please stop charging immediately as it may cause damage to the battery.
3. Do not leave the battery unattended when charging.
4. Do not use other chargers other than the one supplied in consideration of safety.
5. Recharge the battery 30 minutes later after flying, because the battery temperature could be too high when flying and charging immediately could damage the battery.
6. Do not leave the battery in the fire in consideration of safety.
7. Do not short circuit the battery. Do not leave the battery together with tiny medal parts in consideration of safety.

DRONE POWER SWITCH INSTRUCTIONS

Short press the power switch, to turn on the Drones power.
Long press for 3 seconds to turn on the Drones power off.



WIFI APP INSTRUCTIONS

1.SOFTWARE DOWNLOAD AND INSTALLATION:



2. INSTRUCTIONS FOR PAIRING TO A MOBILE DEVICE:

Turn the power switch of the Drone to on, then access the " WIFI SETTINGS" on your mobile device, and find the "APST720W" which corresponds to the "Aerpro Storm" Drone for connection. When pairing is successful, please exit from your WIFI Settings. Open the download App "Aerpro Storm" on the mobile device and then click the "PLAY" icon to access into the control interface for real-time recording.
(Please keep away from other WiFi signals as far as possible when flying.)

MICRO SD CARD RECORDING:

The Drone also has the ability to record to a Micro SD Card (Not included). Insert the Micro SD Card to the underbelly of the Drone see (Fig 1). This drone can support Micro SD card Class level 4/6 or 10. Size 2G/4G or above, Max 32G.

PREPARATION FOR FLIGHT:

1. Please operate in spacious indoor or outdoor without rain or snow,and strong winds. Keep away from people,animals and other obstacles.
2. Make sure the battery of the Drone is well installed and connected. Turn on the power switch of the Drone, the indication lights of the Drone will start flashing, then put the Drone on the flat surface and wait for the frequency adjustment.
3. Turn on the switch of the transmitter, pull the throttle stick to the highest position, and then pull the throttle stick down to the lowest position. The indication lights of the Drone will stop flashing and stay on, frequency adjustment is successful you are now connected to the Drone and ready for flight.

DRONE CONTROLS

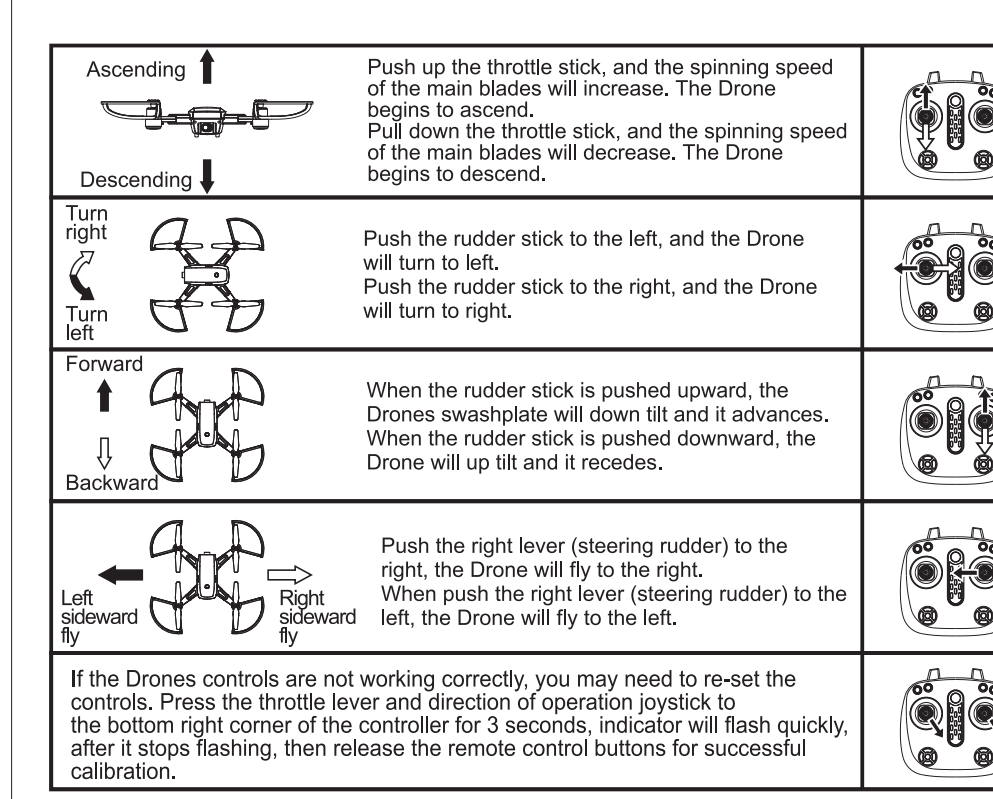

NOTICE: If the drone is rotating in the air uncontrollably, adjust the rudder trimming buttons until the drone is stable.

HEADLESS MODE AND ONE KEY RETURN

Headless mode supports beginners in the initial stages of learning how to fly the drone. Regardless of where the drone turns, the direction of flight always corresponds exactly to the direction specified with the control for forwards/backwards and sideways movements.

1. Place the drone on flat surface facing away from you, turn on the drone and connect the controller.
2. Press the headless mode button, and you will hear a beep, the LED lights flash to indicate that the drone is in Headless mode, you can press the button again to cancel this function.

NOTICE: Blade replacement.

If blades are damaged or need replacing, there are two kinds of blades styles that need to mount to appropriate arms of the Drone. The arms and blades are labeled A and B. Match the correct blade to corresponding arm for the Drone to fly correctly.

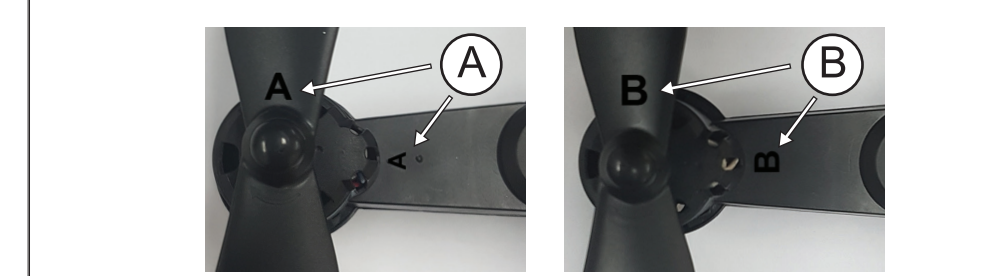

COMMON PROBLEMS AND SOLUTION INSTRUCTIONS:

THE PROBLEM	REASON	COUNTER MEASURES
The indication light of the Drone is flashing and without reaction when operated.	1. Frequency modulation between the Drone and remote control is not operated correctly. 2. Insufficient battery power.	1. Refer to the Preparation for taking off, and re-modulate the frequency. 2. Recharge the battery.
The Drone blades turn around but the Drone cannot take off.	The blades distorted.	1. Recharge the battery. 2. Replace the blades.
The Drone shakes badly.	1. Insufficient battery power. 2. The blades distorted.	Replace the blades
The fine tuning button are all on but the Drone still couldn't keep balance.	1. The blades distorted. 2. The motor doesn't work properly.	1. Replace the blades. 2. Replace the motor.
The Drone loss of control after crashing.	Three-axis acceleration sensor lose it's balance after crashing.	Put the Drone on the ground for 5-10 seconds.

PRECAUTIONS:

1. The remote controlled distance will shorten when the power of the Drone or transmitter is insufficient.
2. It is difficult to take off or fly high when the Drone's power is insufficient.
3. When the Drone is damaged, stop using and get it repaired, or it may lead to injury.
4. If you do not use the transmitter for a long time, please remove the batteries to avoid the batteries' leakage.
5. Do not drop or damage the transmitter otherwise, it will shorten the transmitter's life.

NOTE: Maintaining control of the drone while flying is the sole responsibility of the pilot. Any loss or damage caused while flying is NOT covered by warranty.
This manual is considered correct at time of printing but is subject to change.