

OPERATION

Switch on Camera

1. Press and hold on the  power switch for about 3 seconds to turn on the camera, the power indicator will illuminate and the LCD will become viewable.

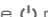
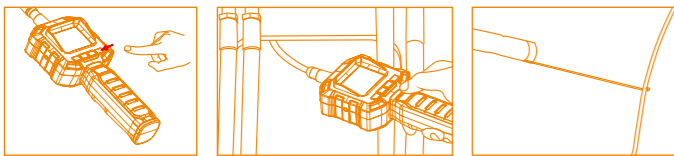

2. When in use, the tube should easily maneuver itself into position. Do not apply excessive force.
3. The flexible tube can be bent into numerous shapes that may help you explore areas you otherwise thought were impossible to see.
4. The accessories included with EXPLORER COMPACT can be used to retrieve small items like dropped rings or screws.

Mirror Image

In real-time monitoring mode, The mirror image can be adjusted by pressing the  button.

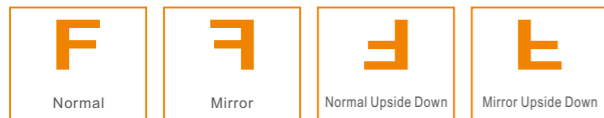

LEDs Brightness Control

The 8 levels of LED brightness can be adjusted by pressing the brightness button in real-time monitoring.

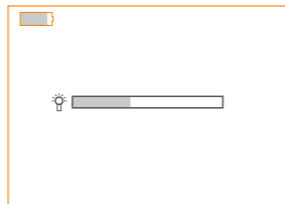

LCD Contrast Control

The 8 levels of LCD contrast can be adjusted by pressing the contrast button in real-time monitoring.



SPECIFICATIONS

	Model No.	Parameter
Camera+Handle	Screen Size	2.31" TFT LCD
	Contrast	300
	Brightness	220CD/M ² (TYP)
	Power Supply	AA x 4 batteries (1.5V x 4)
	Work Time	6Hour (Max.)
	Consumption Current	238mA
	Output Signal Impedance	75ohm
	Output Signal Level	0.9~1.3Vp-p
	Imaging Sensor	1/8-inch CMOS
	Effective Pixels	640 x 480
	Video System	PAL/NTSC
	Horizontal Viewing Angle	48°
	Minimum Illumination	0 Lux (LED ON)
	Waterproof Capacity	IP67 (for lens/tube only)
	Dimensions of Tube	Φ8mm x 980mm (Including Camera)
Dimensions of Handle	257 x 92 x 44(mm) (Excluding Flexible Tube)	
Operating Temperature	-10°C~50°C/14°F~122°F	
Operating Humidity	15~85%RH	
Approx. Weight	407g (Including Batteries)	

※ All specifications are subject to minor change without prior notice.

FCC INFORMATION

This device complies with part 15 of the FCC Rules. Operation is subject to the following two conditions:

- (1) This device may not cause harmful interference;
- (2) This device must accept any interference received, including interference that may cause undesired operation. Changes or modifications not expressly approved by the party responsible for compliance could void the user's authority to operate the equipment.

EU Environmental Protection

Waste electrical products should not be disposed of with household waste. Please recycle where facilities exist. Check with your local authority or retailer for recycling advice.



EXPLORER COMPACT

USER MANUAL

Inspection Camera
with Color LCD Monitor

INSPECTION TOOL

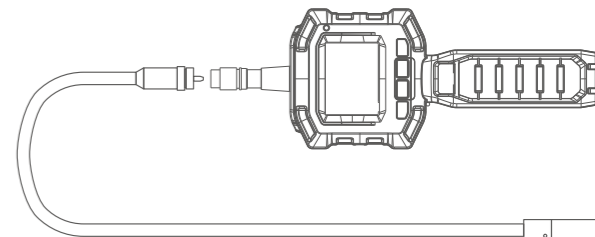

Version 1.0

Please read this user manual carefully before using this product. Failure to understand operation procedures may result in injury.

Model: GL8898

GENERAL SAFETY INFORMATION

WARNING! Read and understand all instructions. Failure to follow all instructions listed below may result in electric shock, fire and/or serious personal injury.

SAVE THESE INSTRUCTIONS!

- ※ Prevent object and liquid entry. Never spill liquid of any kind on the video display unit. Liquid increases the risk of electrical shock and damage to the product.
- ※ The unit is not shock-resistant. Do not use Explorer Compact as a hammer and avoid high impact resultant from things such as dropping the unit from height
- ※ Do not immerse camera handle or LCD screen in water. Avoid moisture, and store product in a dry place. Such measures reduce the risk of electric shock and damage. *The lens and the tube are water resistant when the unit is fully assembled, but the LCD screen and handle are not.*
- ※ Do not use the camera if condensation forms inside the lens. Let the water evaporate before using again.
- ※ Turn off the system if it is not in use.
- ※ Attention should be given to the environmental aspects of battery disposal.
- ※ Remove the batteries when cleaning the unit.
- ※ Remove the batteries before storing the unit for a long time.
- ※ When necessary, REPLACE ALL FOUR (4) BATTERIES in this unit with new ones, not one (1) or two (2) batteries at a time.
- ※ Use only the size and type of battery specified.
- ※ Be sure to install the battery with the correct polarity as indicated in the battery compartment.
- ※ Properly dispose of batteries. Exposure to high temperatures can cause batteries to explode, so do not dispose of in a fire. Place tape over the terminals to prevent direct contact with other objects.
- ※ Some countries have regulations concerning battery disposal. Please follow all applicable regulations.

WELCOME

Congratulations on your purchase of our inspection video camera with recordable color LCD screen, the EXPLORER COMPACT. Please read the user manual carefully before using this product. This product is designed as a remote inspection device, live time video streaming. Appropriate for use in surveying pipes or other hard-to-reach places, equipment or furnishing installation, car repair, etc. Features include waterproof LED lens, real-time viewing.

FEATURES

- Allows for easy surveying of small, hard-to-reach places
- Mini water-proof camera with 980mm(3ft) flexible extended tube
- Manufactured and tested to IP67 waterproof standard
- 2.31" TFT-LCD monitor
- Adjustable brightness on lens-mounted LED light
- 4 useful accessories included: hook, mirror and magnet
- Lightweight, handheld design, flexible and convenient to use

PACKING LIST



※ GL8898 = GT8898(handle) + GT4818(camera)

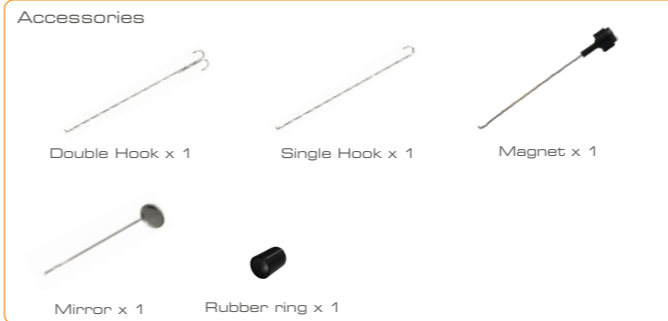

STRUCTURE



INSTALLATION

To Install Batteries (Dry your hands before installation or replacing batteries.)

1. Remove battery cover;
2. Extract the battery box from the handle, Insert four (4) AA batteries into their appropriate slots, with proper orientation, as indicated on the battery compartment;
3. Replace battery cover.

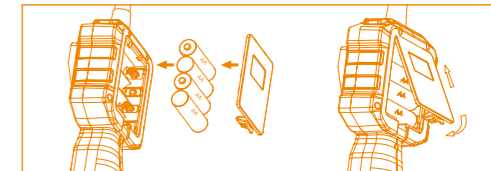

To Attach Flexible Tube with Handle

To connect the flexible tube camera with control handle, first make sure that the keyed end of the tube is aligned with the slot in the handle, then use slight force to push them together. Once properly aligned, twist the threaded knob clockwise until the connection is securely in place.

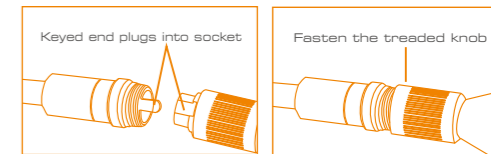

To Install Accessories

The three (3) included accessories (mirror, hook and magnet) are all attached to the camera in the same way as illustrated below:

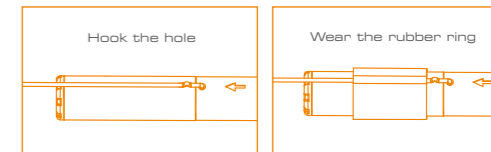

Video Output

Insert video cable into the video out socket of the monitor, insert the other end of the cable into the video in jack of any compatible TV or display device. The LCD monitor is now capable of outputting high quality video to another display.

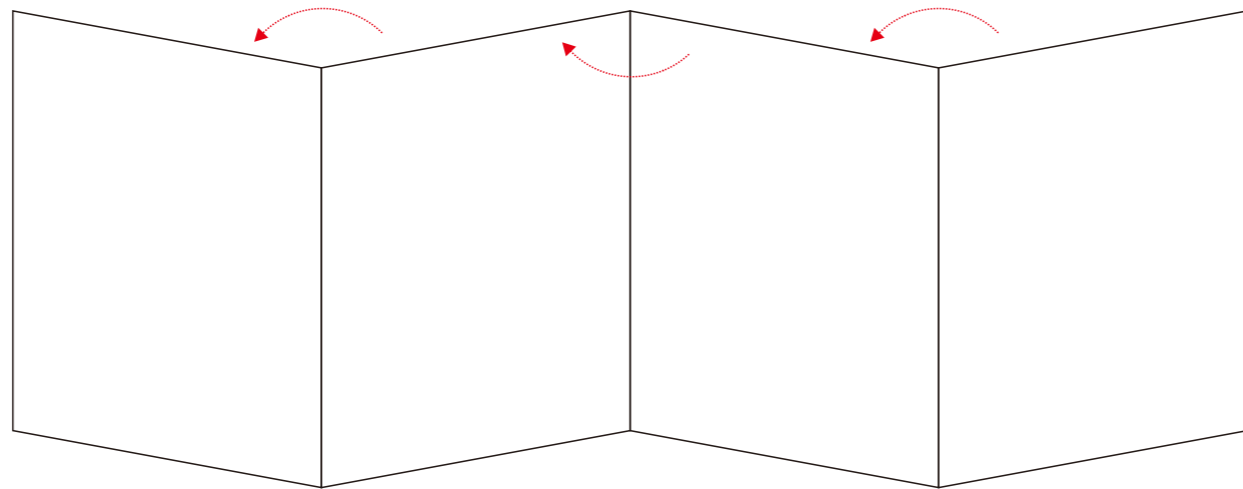

折叠示意图

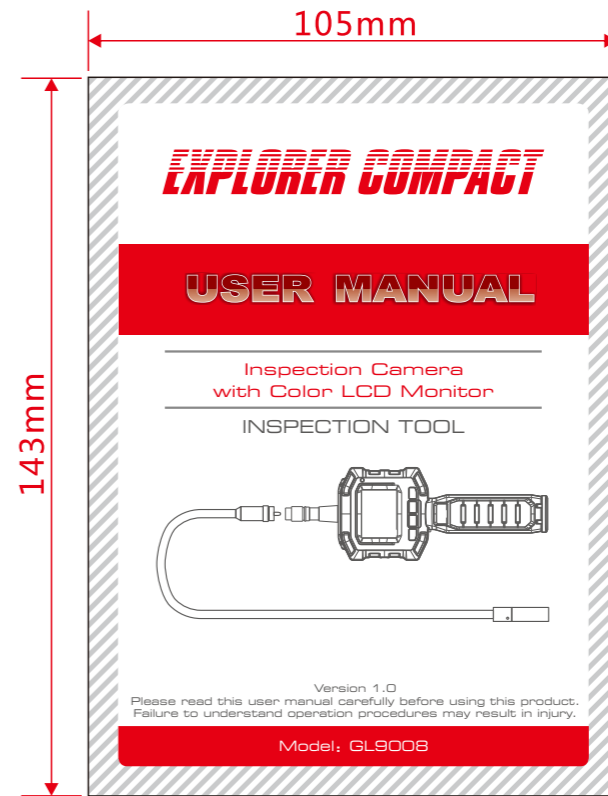

折叠后成品尺寸：105*143mm

展开尺寸：420*143mm

材质：105g铜版纸

颜色：4C 正反两面印刷