



G9120

INSPECTION CAMERA

HD 720P Camera Resolution

USER MANUAL



aerpro.com

THANK YOU

Congratulations on your purchase of our Aerpro G9120 inspection video camera. Please read the user manual carefully before using this product. This camera can live stream as well as record video to a Micro SD card.

FEATURES

- Monitor**
- 4.3" TFT LCD monitor
 - 800 x 480 Screen resolution (RGB)
 - Supports Micro SD card up to 32GB (Not included)
 - 2x variable digital zoom
 - JPG photo format
 - AVI video format
 - Power supply 4AA batteries (Not included)
- Camera**
- 5.2mm Flexible camera head (1.0M length)
 - 1280 x 720 Effective pixels
 - 50° Optical lens viewing angle
 - LED Torch light
 - CMOS Image sensor
 - IP67 Waterproof level

INCLUSIONS

- 1x Inspection camera
- 1x Magnetic tip
- 1x Mirror tip
- 1x Hook tip
- 1x Protective case
- 1x User manual

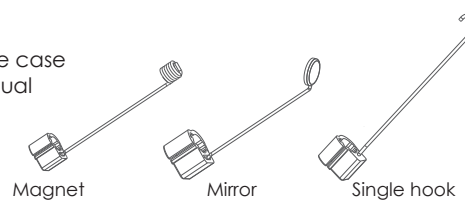

-1-

STRUCTURE

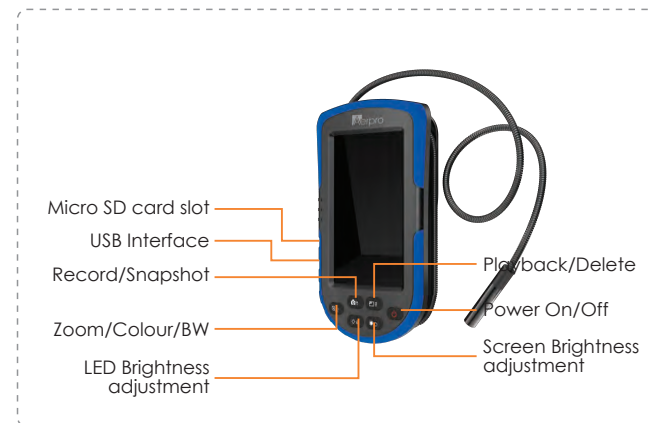

INSTALLATION AND USE

1. Open the back cover of the battery compartment. Insert 4AA batteries (Not included). Close the back cover. Unwind the cable to the required length. Press and hold the power button to turn the camera on.



-2-

INSTALLING ATTACHMENTS

2. Slide an attachment over the base of the camera. Gently squeeze the black mounting module at the base of the attachment to secure in place around the camera.



3. To turn the inspection camera On/Off press and hold the power button until the screen displays the startup screen. Press and hold the power button to turn off inspection camera.



-3-

4. Short press to take a picture (snapshot). Long press to record.

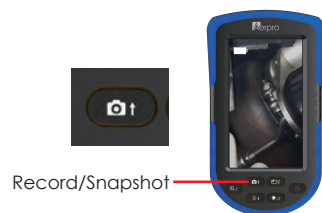

NOTE: Before recording, please format your Micro SD card on your computer. When formatting your card, set the cluster size to 64KB. The capacity of the card only supports 2G ~ 32G.

5. Short press to view a picture or video. Long press to delete them.



6. Short press the screen adjustment to adjust the screen brightness. After the screen reaches the maximum brightness, press again to restore.

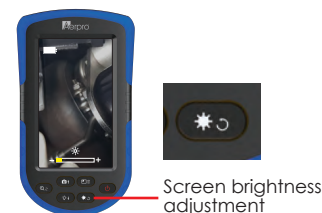

-4-

7. To adjust the camera's LED light brightness, short press to turn it on, short press again to change intensity. After it reaches maximum press again to turn off.

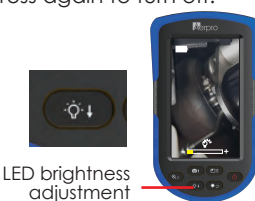

8. Zoom/Black & White: Short press to zoom. Once for 1.5X magnification, twice for 2.0X magnification. Long press to switch to black & white mode.



9. Flip & mirror: Long press to flip and mirror the image

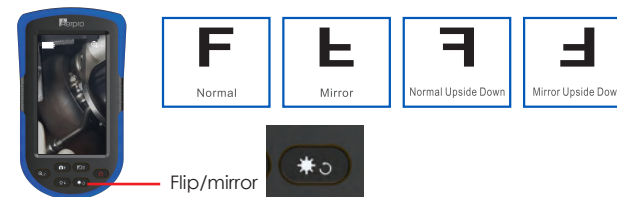

NOTES:

1. Do not over bend the camera lens cable with force particularly where it connects to the receiver.
2. The camera lens and cable is waterproof but the receiver is not.
3. When the product is not in use, remove the batteries.

-5-

CAMERA

| Items | Specifications |
|-------------------------|----------------|
| Diameter Of Camera Head | φ5.2mm |
| Image Sensor | CMOS |
| Effective Pixel | 1280*720pixels |
| Waterproof Level | IP67 |

MONITOR

| Items | Specifications |
|--------------------------|--------------------------|
| Display Size | 4.3" TFT LCD monitor |
| Screen Resolution | 800 x 480 (RGB) |
| TF card support capacity | 2~32G |
| Image Zoom | 2x variable digital zoom |
| Photo Format | .JPG |
| Video Format | .AVI |
| Interface | Micro USB |
| Power Supply | 4AA Batteries |
| Power consumption | 360mA (MAX) |
| Operation Temperature | -10~+50°C |
| Storage Temperature | -20~+60°C |
| Operation Humidity | 15%~85%RH |

-6-

FCC INFORMATION

This device complies with part 15 of the FCC Rules. Operation is subject to the following two conditions:
(1) This device may not cause harmful interference;
(2) This device must accept any interference received, including interference that may cause undesired operation. Changes or modifications not expressly approved by the party responsible for compliance could void the user's authority to operate the equipment.

EU Environmental Protection

Waste electrical products should not be disposed of with household waste. Please recycle where facilities exist. Check with your local authority or retailer for recycling advice.



TECHNICAL ASSISTANCE

If you need assistance setting up or using your Aerpro product now or in the future, call Aerpro Support Australia
TEL: 03 - 8587 8898 FAX: 03 - 8587 8866
Mon-Fri 9am - 5pm AEST

This manual is considered correct at time of printing but is subject to change.

For latest manuals and updates refer to the website.

AERPRO.COM