

Installation manual for:
CTKFD40C
Ford Ranger

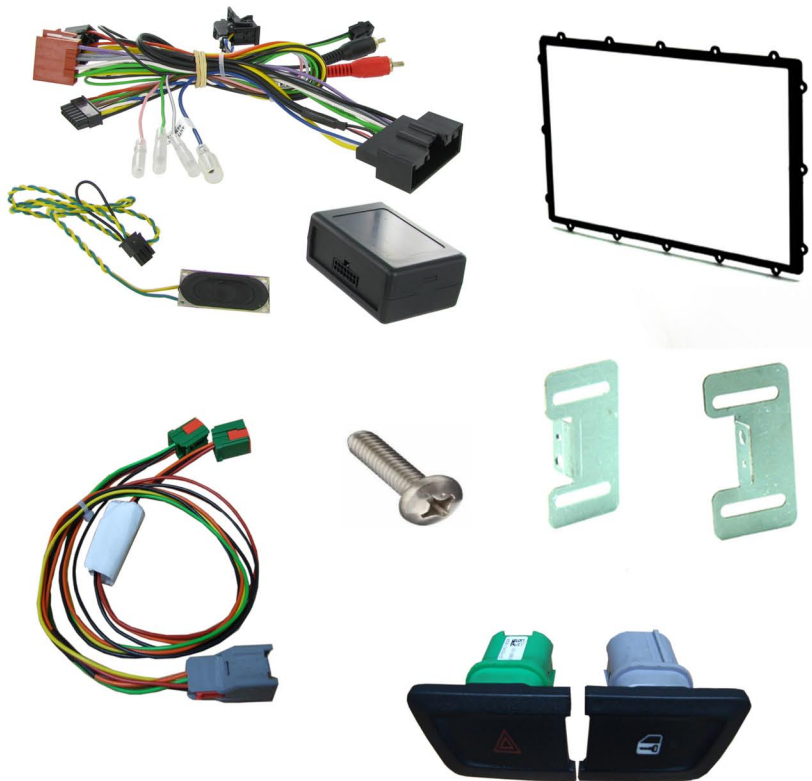

Installation kit includes the following items:

- 1x Replacement Panel
- 1x Switch Lead
- 1x Replacement Trim
- 1x Mini Speaker
- 1x Interface lead
- 1x Interface Box
- 1x Hazard Switch
- 1x Door lock Switch
- 2x Mounting Plates
- 4x Screws

Installation Guide

Part No: CTKFD40C

Ford Ranger 2012>

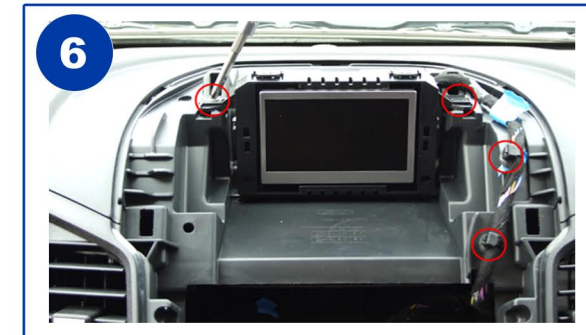
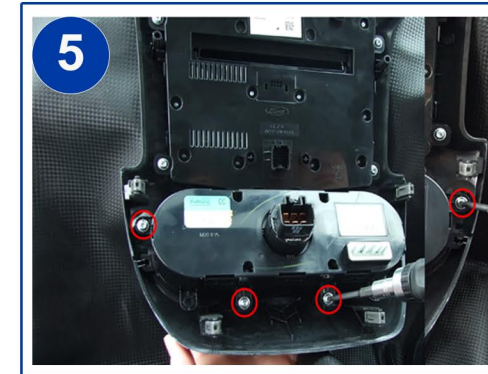
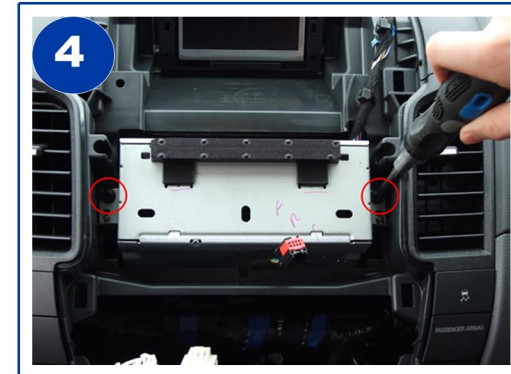
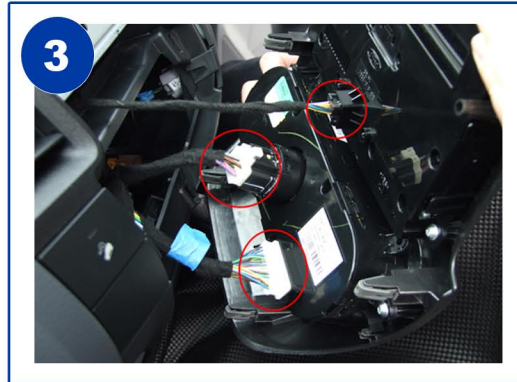
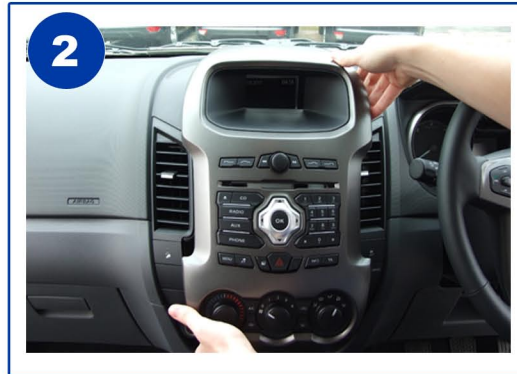
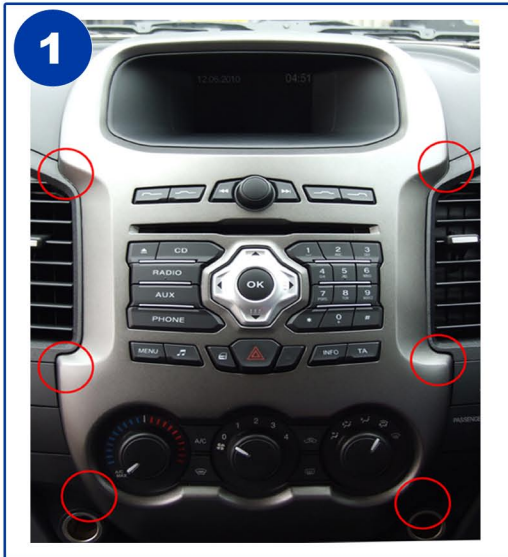

1 Remove the OEM plastic fascia with plastic removal tools - use the lever tools in the highlighted area's.

2 Once the fascia is unclipped, pull the fascia towards the rear of the vehicle

3 Unplug the three OEM connectors from the back of the fascia

4 Unscrew the two screws highlighted, then remove the head unit.

5 Remove heater controls by removing the screws highlighted then fit the heater controls into the new fascia

6 Remove the display by unscrewing the two screws on top of the display. Then unclip the display loom clips where highlighted

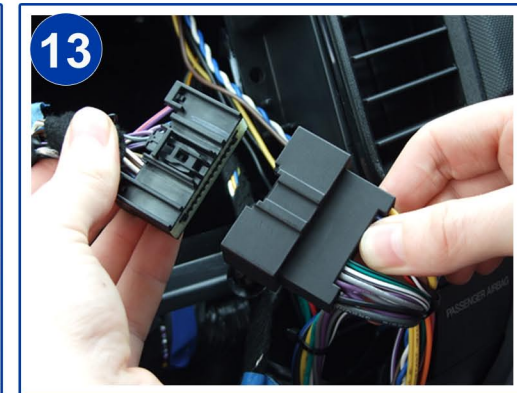
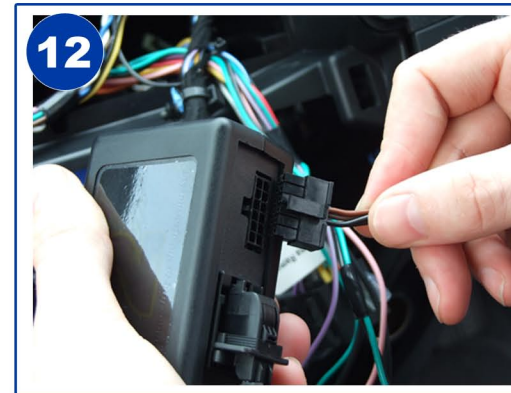
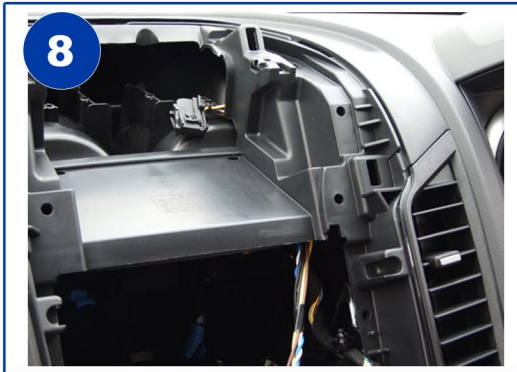

7 Remove the OEM display connector

8 Feed the Connects2 stalk display harness up through the dash - As shown in picture

9 Connect the Connects2 stalk display connector into the OEM display and refit the display

10 Plug the OEM display connector into the Connects2 interface box

11 Plug the Stalk loom connector (14 Pin connector) into the interface box

12 Plug the connects2 stereo patch lead into the interface

13 Plug the main OEM connector into the Connects2 main connector

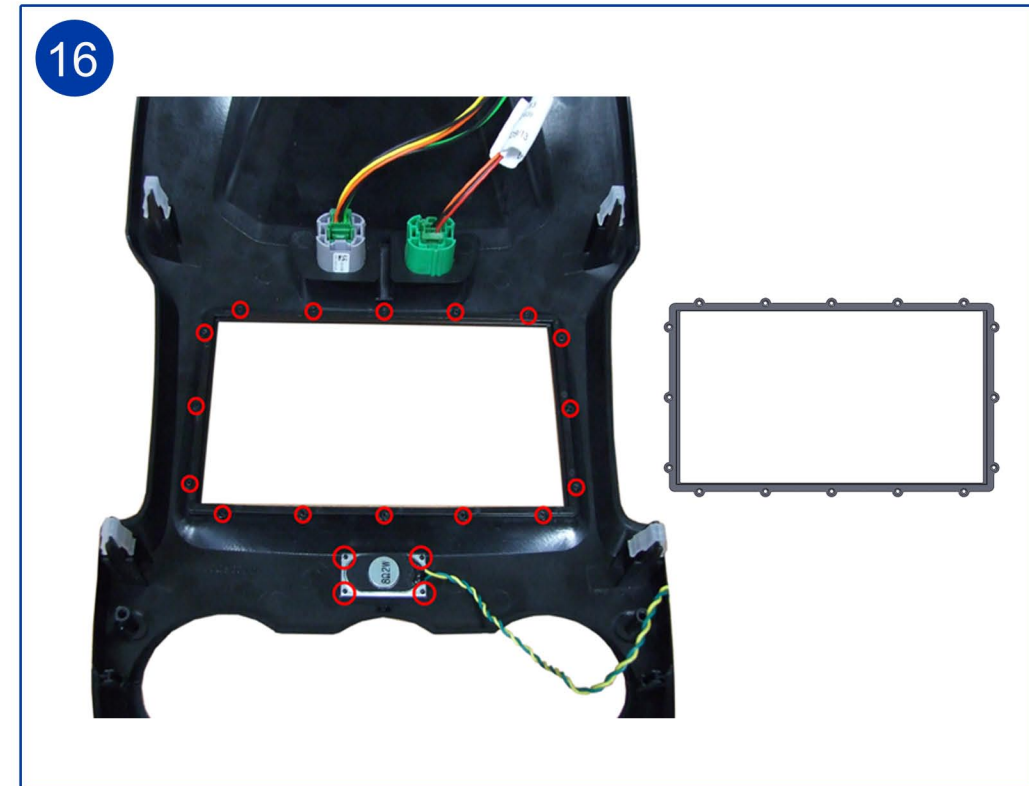
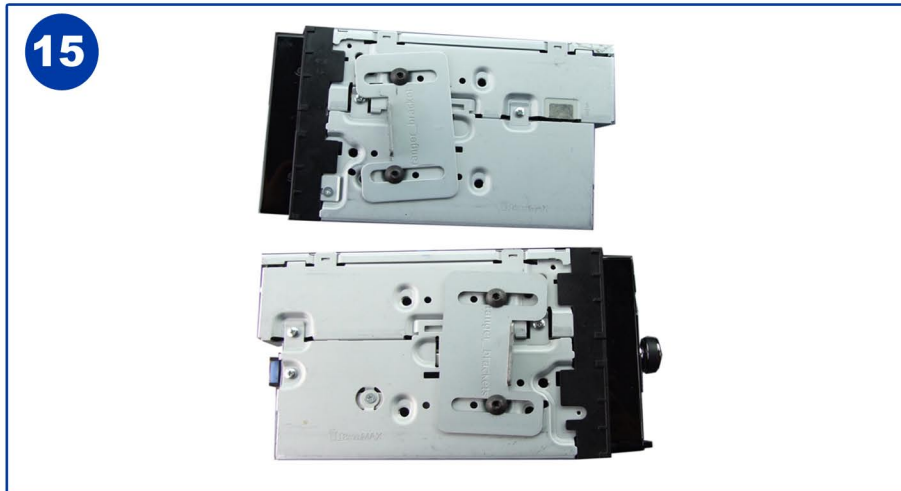
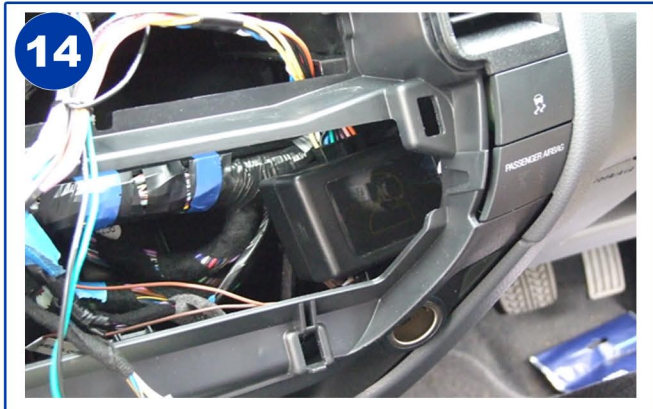

14 Tuck and hide away the stalk interface box

Remove clips from Connects2 fascia
 Fit stereo brackets - Dont fully tighten
 Fit stereo into dash - Test fit
 Test fit fascia - manipulated stereo into final position
 Remove fascia

15

Remove stereo - Being careful not to move the brackets
 Fully tighten stereo brackets
 Re-fit stereo
 Re-fit fascia clips

16

Place the speaker onto the Connects2 fascia and with a soldering iron, melt the four plastic tabs (highlighted in the picture) in the corner of the speaker.

Try the supplied trim around the face of the head unit first before melting into please (highlighted in th picture). If the trim does not fit around face of head unit then trim is not needed

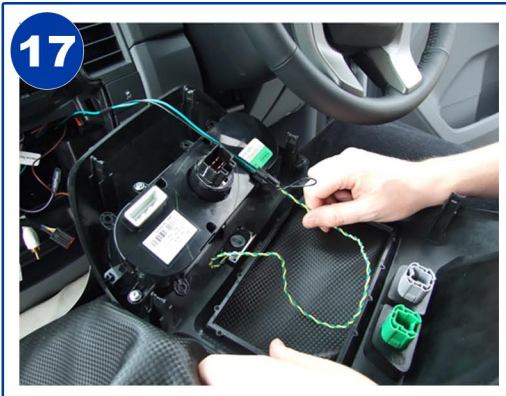

17

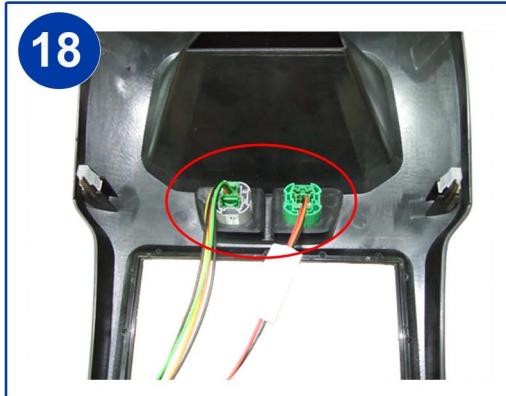

18

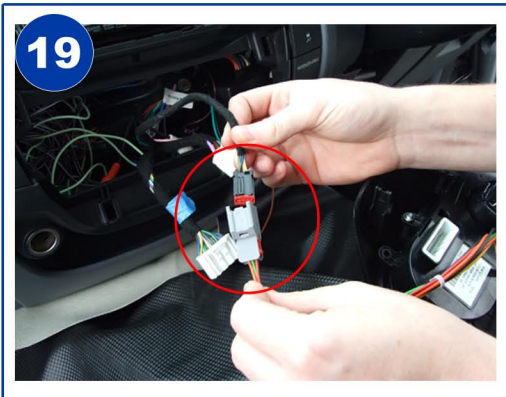

19

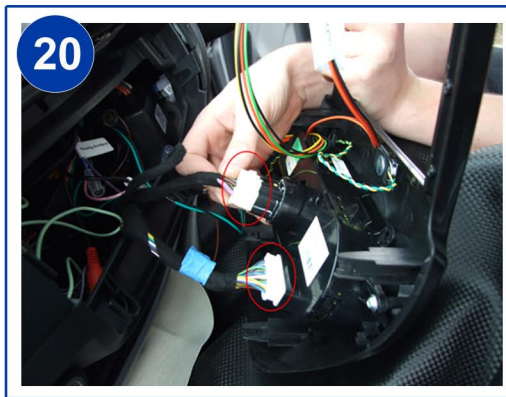

20



21



22

17 Connect up the mini speaker connector

18 Plug the Connects2 cable into the Hazard and door lock switch connectors at the top of the fascia (Grey switch first)

19 Connect the other end of the switch connector cable onto the vehicles harness

20 Reconnect the heater controls

21 Unclip switch wire from switches and feed the switch connector wires around the head unit and tidy up the wiring behind the heater controls to allow the fascia to clip into place correctly

22 Finally fit the fascia into place and the install is complete