

# APWMVLOK Manual

## FEATURES

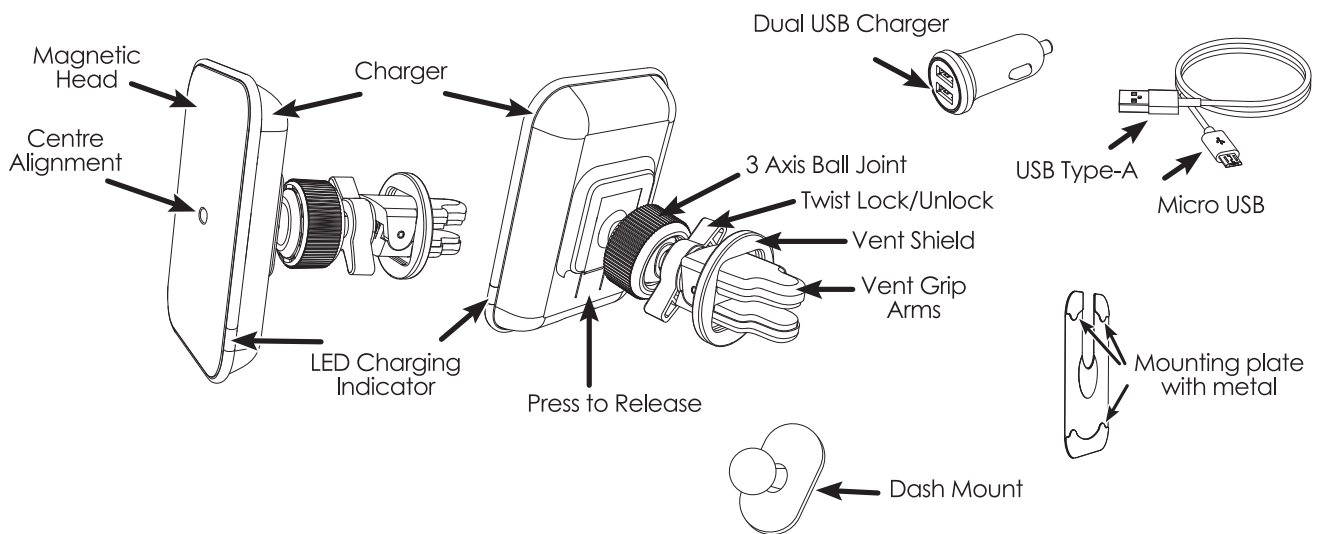

Note: Dash Mount can be used as an alternative to the Vent Mount. Loosen ball joint collar. Pull ball joint out of socket. Place collar over dash mount ball. Push dash mount ball back into socket. Tighten collar.

## INSTRUCTIONS

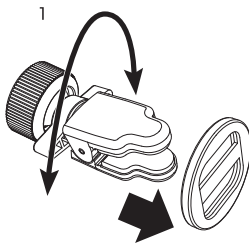

1 Place Vent shield over grip arms. Twist clockwise to tighten grip arms, twist anti-clockwise to loosen

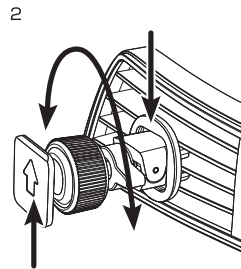

2 Arrow faces upwards when mounting to charger. Twist clockwise to loosen 3 Axis ball joint, twist anti-clockwise to tighten

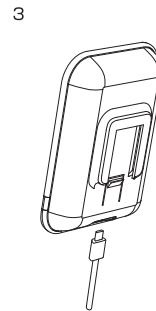

3 Insert Micro USB end of the cable into the base of the wireless charger and USB Type-A end in to a USB charger

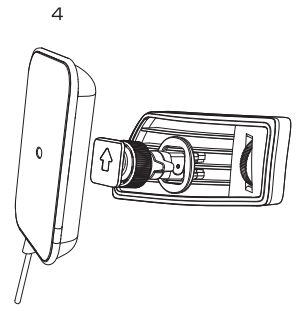

4 Slide onto base of wireless charger

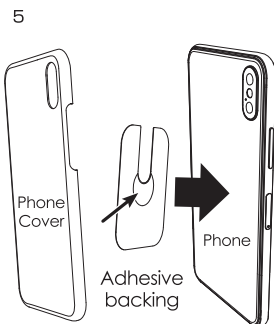

5 The mounting plate sticks to the back of the phone directly. Remove protective adhesive cover to adhere to phone. Then the phone's cover covers the plate.

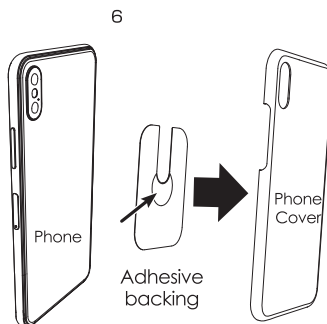

6 The mounting plate can also be fitted inside the cover of the phone. Remove protective adhesive cover to adhere to phone cover. To maximise charging efficiency please ensure the plate is centred with the phone

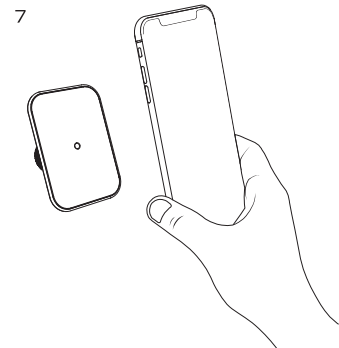

7 Once the mounting plate is fitted on the back of the phone or inside phone cover, align the centre of your phone with the circle on the holder to charge. LED charge indicator will turn red while charging. If indicator flashes red, reposition phone for better connection.

## APWMVLOK Manual

### PRODUCT SPECIFICATIONS

Certification	Qi-ID 4456
Output Wattage	5 Watt
Input Voltage	4.75 - 5.25 V
Max Current	1.5A
Input Connector Type	Micro USB
Frequency	110 - 250 KHz
Protection	Over and Low Voltage
	Over and Low Current
	Over Heat
	Foreign Object Detection
	Over Distance
Workable Temperature	-10~30°C



Please visit us at  
[www.aerpro.com](http://www.aerpro.com)

Suitable for all wireless  
Qi-enabled devices

### TECHNICAL ASSISTANCE

If you need assistance setting up or using your Aerpro product now or in the future, call Aerpro Support Australia.

TEL: 03 – 8587 8898  
FAX: 03 – 8587 8866  
Mon-Fri 9am – 5pm AEST

Please retain this user guide for future reference.

If you would like to download a digital copy of this manual, or other aerpro manuals/software, please visit the <http://aerpro.com.au> website and click on 'Find things instantly' to search for information on this product.

This manual is considered correct at time of printing but is subject to change. For latest manuals and updates refer to the website.

Copyright © 2017 by TDJ Australia

All rights reserved. No part of this publication may be reproduced, distributed, or transmitted in any form or by any means, including photocopying, recording, copying or other electronic or mechanical methods, without the prior written permission of the author.