

APWHVLOK Manual

FEATURES

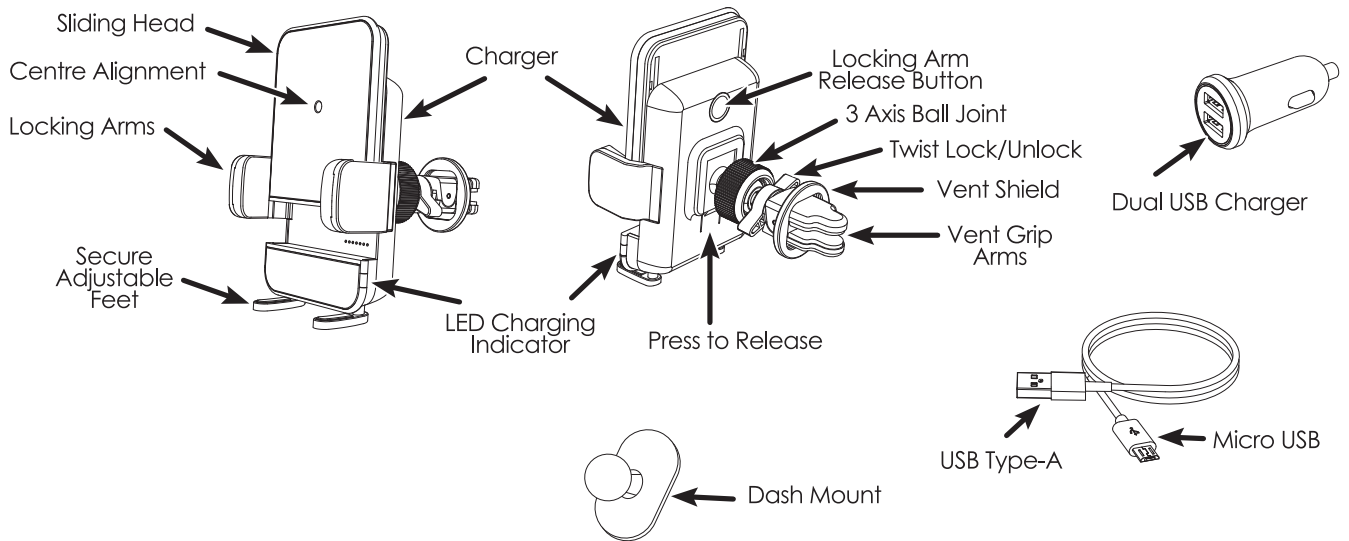

Note: Dash Mount can be used as an alternative to the Vent Mount. Loosen ball joint collar. Pull ball joint out of socket. Place collar over dash mount ball. Push dash mount ball back into socket. Tighten collar.

INSTRUCTIONS

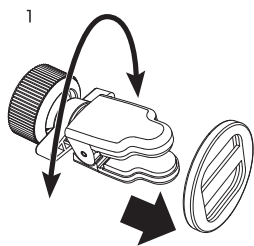

1 Place Vent shield over grip arms. Twist clockwise to tighten grip arms, twist anti-clockwise to loosen.

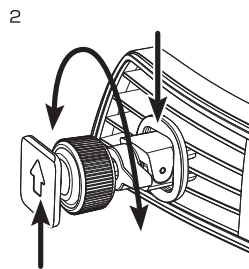

2 Arrow faces upwards when mounting to charger. Twist clockwise to loosen 3 Axis ball joint, twist anti-clockwise to tighten.

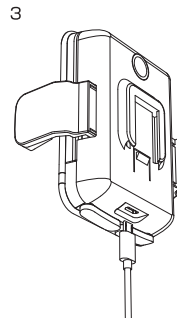

3 Insert Micro USB end of the cable into the base of the wireless charger and USB Type-A end in to a USB charger

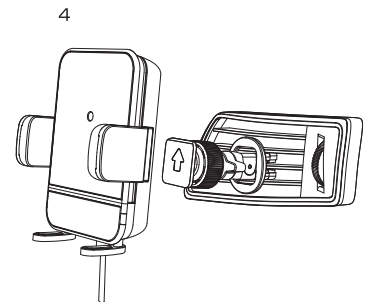

4 Slide onto base of wireless charger

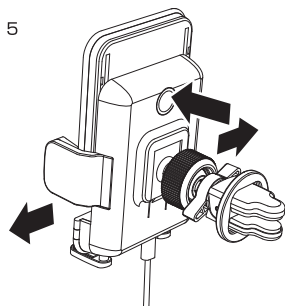

5 Press locking arm release button to extend arms

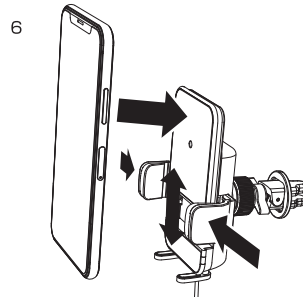

6 Place phone in holder and press arms inwards for secure grip on phone. Adjust sliding head to appropriate position. LED charge indicator will turn red while charging. If indicator flashes red, reposition sliding head for better connection.

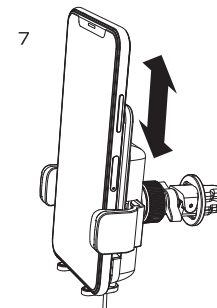

7 To remove phone release arms and slide phone upwards

APWHVLOK Manual

PRODUCT SPECIFICATIONS

Certification	QHD 4456
Output Wattage	5 Watt
Input Voltage	4.75 - 5.25 V
Max Current	1.5A
Input Connector Type	Micro USB
Frequency	87 - 205KHz (Qi Standard 1.2.4)
Protection	Over and Low Voltage
	Over and Low Currency
	Over Heat
	Foreign Object Detection
	Over Distance
Workable Temperature	-10~28°C



Please visit us at
www.aerpro.com

Suitable for all wireless
Qi-enabled devices

TECHNICAL ASSISTANCE

If you need assistance setting up or using your Aerpro product now or in the future, call Aerpro Support Australia.

TEL: 03 – 8587 8898
FAX: 03 – 8587 8866
Mon-Fri 9am – 5pm AEST

Please retain this user guide for future reference.

If you would like to download a digital copy of this manual, or other aerpro manuals/software, please visit the <http://aerpro.com.au> website and click on 'Find things instantly' to search for information on this product.

This manual is considered correct at time of printing but is subject to change. For latest manuals and updates refer to the website.

Copyright © 2017 by TDJ Australia

All rights reserved. No part of this publication may be reproduced, distributed, or transmitted in any form or by any means, including photocopying, recording, copying or other electronic or mechanical methods, without the prior written permission of the author.