

## WIRELESS CHARGING POWERBANK

Thank you for purchasing the APPB100 Wireless Charger/Power Bank. It is compatible with all Qi enabled devices like Samsung S7/ S8, S9, S10, iPhone8, iPhone8 plus, iPhoneX, etc. For optimum performance and safety, please read this manual carefully before using this product.



## Product Diagram:

1. Wireless charging contact area
2. Suction cups
3. USB charging output socket
4. Micro USB power input socket
5. Wireless charging status indicator light
6. Power level indicator light
7. On/Off power switch

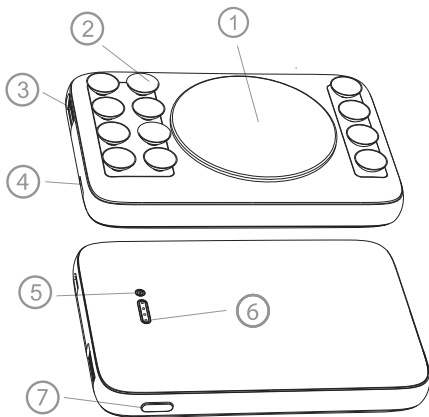

## Product Specifications:

- WPC Qi Certified
- Wireless Output: 5W
- Input Voltage: 5V/2A
- Output Voltage: 5V/1A
- USB Output Voltage: 5V/2A
- Charging Efficiency:  $\leq 75\%$
- Transmission Distance:  $\leq 6\text{mm}$
- Battery: Li-Polymer, Grade A
- Battery Capacity: 5000mAh
- Dimensions: 96x63x15mm
- Weight: 128g



## Charging the APPB100:

1. Connect the included Micro USB cable to the power input socket on the wireless charging powerbank.
2. Connect the opposite end of the cable into a USB car charger or USB power adapter (not included).
3. The wireless charging power level indicator will light up when plugged into a power source and indicate the current power level.



## Power Level Indicator Light:

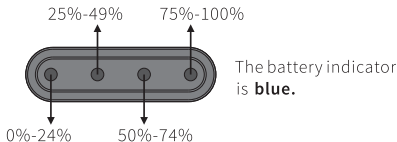

## Charging Your Device (USB Port):

1. Insert a USB cable into the USB charging output socket.
2. Connect the opposite end of the cable into a USB device or smartphone
3. Press on the power switch button on the wireless charging powerbank to begin charging. The wireless charging power level indicator will light up indicate the current power level of the powerbank.

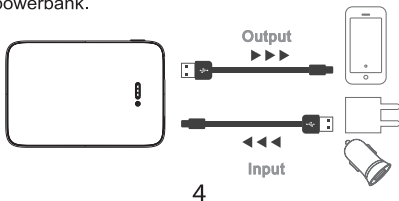

## Charging Your Device (Wireless):

1. Turn on the device using the on/off power switch. The wireless charging indicator light will turn red to indicate standby mode.
2. Place the Qi-enabled device on the wireless charging pad's wireless charging contact area. This is the suction cup side of the wireless charging powerbank.
3. When successfully charging, the wireless charging indicator light will turn green.
4. Ensure the section cups are securely stuck to the device to ensure the wireless charging powerbank does not fall off during use.
5. If the wireless charging indicator light flashes blue and red then there is a problem with the connection. Ensure there are no objects between your device and the wireless charging pad. You may also need to reposition your device on the wireless charging pad to fix the problem.

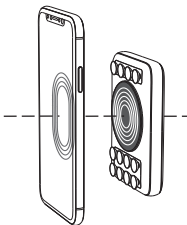

Place the single row suction cups on the back of the smartphone directly below the camera. On most smartphones the powerbank should be positioned below the camera so the camera can still be used.

## Charging Indicators:

Indicator colour	Effect
Red	Wireless charging stand-by
Green	Wireless charging
Red & Green flashes	Abnormal operation (reposition or fault)

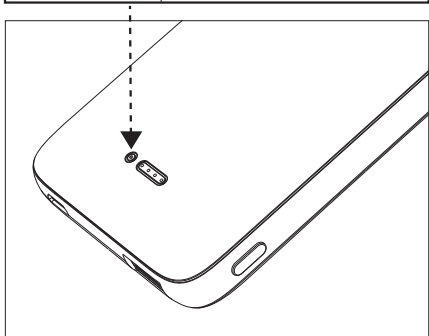

## **Inclusions:**

- Wireless charging powerbank
- 30cm Micro USB power cable
- User manual

## **Important Notes:**

1. This device requires a USB charger to operate (not included). When connecting to a USB charger ensure it has the correct power output voltage as per the Specifications on page 2 of this manual. It should meet QC2.0 Quick Charge Standards as a minimum, for optimal charging QC3.0 or QC4.0 standards are recommended.
2. Using a charger or adapter with a lower output than specified on page 3 of this manual may result in malfunction or overheating.
3. Charging speed may vary depending on device specifications, input voltage and environment.
5. Phone cases or metal plates for magnetic attachment may interfere with wireless charging.
6. It's normal for the charger and your device to get hot whilst charging. It will get even hotter if the device is also being used while charging. Allow charger to cool if it gets too hot.
7. When in standby state, the powerbank will automatically turn off if not in use after 20 seconds.

## **Technical assistance:**

If you need assistance setting up or using your Aerpro product now or in the future, call Aerpro Support Australia

TEL: 03 – 8587 8898 FAX: 03 – 8587 8866  
Mon-Fri 9am – 5pm AEST

If you would like to download a digital copy of this manual, or other Aerpro manuals/software, please visit the <http://aerpro.com> website. This manual is considered correct at time of printing but is subject to change. For latest manuals and updates refer to the website.



[www.aerpro.com](http://www.aerpro.com)